

WINDSOR

FITTING INSTRUCTIONS

CAUTION - Due to the press fit nature of this hardware, care should be taken when marking door for mortises. Please recheck all detail prior to drilling.

1. Mark lock position on door at desired height.
2. Drill or rout the mortise slot a depth of 70mm. Fit lock into mortise and scribe around face plate. Remove lock and rout or chisel out to accept lock face (2mm).
3. To fit keeper, slide door into closed position and transfer lock markings to door jamb. Mark centre of lock bolt in retracted position. Centre up keeper hole with centre of bolt. Screw keeper plate to jamb and scribe around outside. Mark centre hole for mortice, remove plate and mortice centre hole to a depth of 20mm. Rout or chisel out jamb to accept keeper plate (2mm). Note - ensure mortice is cut low enough to clear bolt when it is extended. Bolt extends outwards and downwards.
4. For flush pulls mark and drill holes at required backset and height, to line up with lock square drive. Drill from both sides of door for neat cut outs. Hole size is 48mm diameter. Shorten spindle to suit door width. Clear holes of any waste and evenly press fit flush pulls. Fit screw to escape side to complete.
5. If using door edge pull, mark position on door at required height. Mark drill bit to give depth of 25mm and drill in one movement for a neat fit. Hole diameter 25mm. Clear hole of any waste and press edge pull evenly into hole. Note - edge pull has a larger inside lip to bottom. For superior fixing of ring pull, use a construction adhesive when fitting.

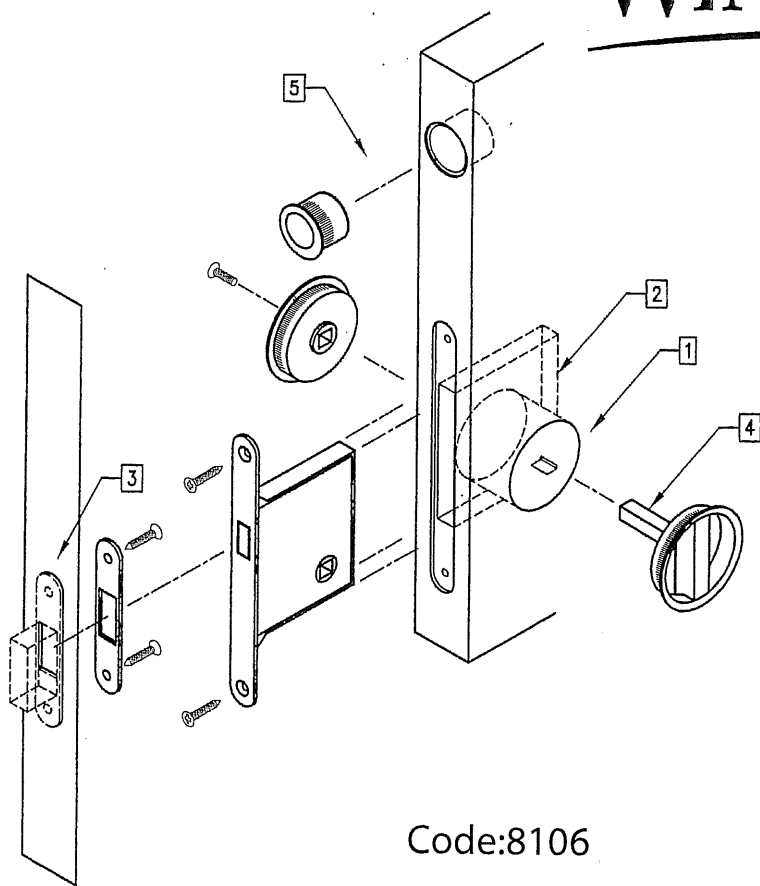

Code:8106

Copyright Windsor Brass Ltd 2005